

ACCENT: Turning ON the Device with a Switch

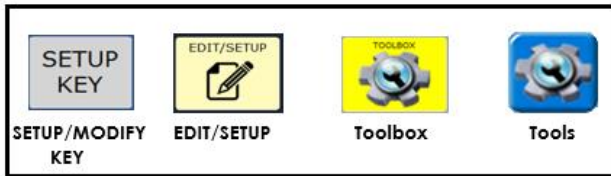

Click [HERE](#) to download NuVoice PASS

Technical Support:

01733 370 470 (Option 2)
Email: info@liberator.co.uk

Regional AAC Consultants:

If you wish to speak to your Regional AAC Consultant, please call 01733 370 470 (Option 3)

You can turn on the **ACCENT 1400 (30 series)**, and the **ACCENT 800 & 1000 (30 and 40 series) devices**, running **NuVoice** and **Grid 3**, from shutdown with a switch. This function is available for the following access methods: **TOUCH; 1-SWITCH; 2-SWITCHES; EYEGAZE.**

Setting Up Your Switch to turn ON the Accent

You will need an adaptor that is a 3.5mm stereo jack plug to either a single or twin 3.5mm mono socket(s). This would allow you to connect into one or two switches. The adaptor will look:



1. Insert your adaptor into one of the switch ports of the Accent.
2. Plug your switch or switches into the mono port(s) of the adaptor.
3. Set your switch access settings as required within the **Access** menu.
4. Shutdown the device as normal.
5. Hit your switch to turn the device **ON**.

